

Clarke®

air

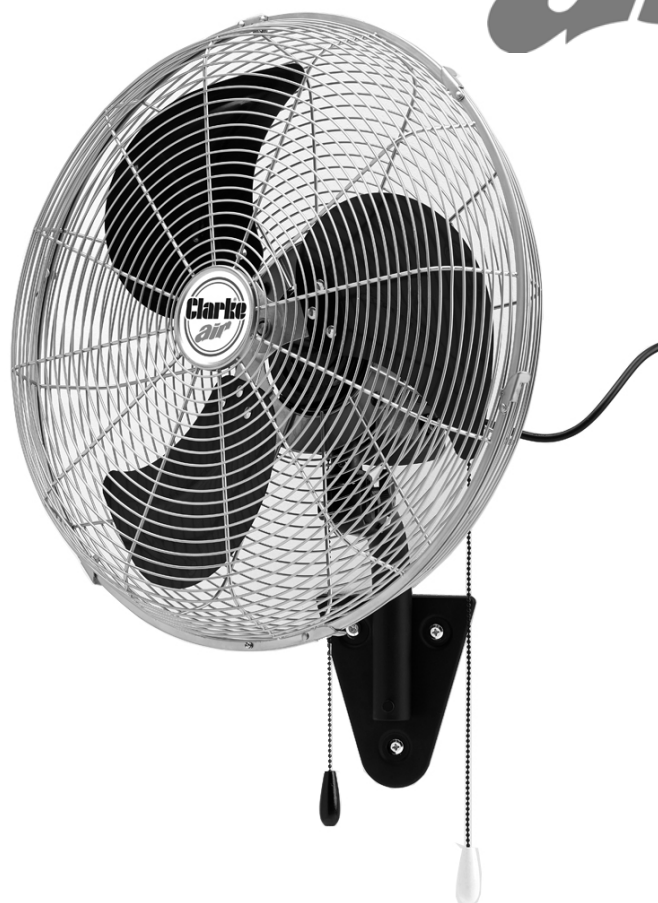

HIGH VELOCITY WALL FAN

MODEL NO: CHV18WF

PART NO: 3231800

OPERATION & MAINTENANCE INSTRUCTIONS

UK
CA | CE



ORIGINAL INSTRUCTIONS

DL1022 - ISS 4

INTRODUCTION

Thank you for purchasing this CLARKE Wall Fan.

Before attempting to use this product, please read this manual thoroughly and follow the instructions carefully. In doing so you will ensure the safety of yourself and that of others around you, and you can look forward to your purchase giving you long and satisfactory service.

ENVIRONMENTAL RECYCLING POLICY



By purchasing this product, the customer is taking on the obligation to deal with its safe disposal in accordance with the Waste Electrical and Electronic Equipment (WEEE).

In effect, this means that this product must not be disposed of with general household waste. It must be disposed of according to the laws governing Waste Electrical and Electronic Equipment (WEEE) at a recognised disposal facility.

If disposing of this product or any damaged components, do not dispose of with general waste. This product contains valuable raw materials. Metal products should be taken to your local civic amenity site for recycling of metal products.

SAFETY PRECAUTIONS

1. **ALWAYS** read this manual before use.
2. **DO NOT** use in environments containing chemical fumes etc.
3. **DO NOT** use as an extractor fan.
4. **DO NOT** use in areas of high humidity/water vapour, i.e. bathrooms etc.
5. **DO NOT** connect the fan to a duct system.
6. **DO NOT** cover the fan with clothing or any material that will restrict free airflow through the fan.
7. **NEVER** touch the blades with your hand or any object.
8. **ALWAYS** unplug the fan before performing maintenance. Don't touch the fan when your hands are wet.
9. **DO NOT** attempt to disassemble, repair or rebuild the fan.
10. **NEVER** use the fan if the cable or plug are damaged.
11. **NEVER** use the fan close to fires.
12. **DO NOT** use this fan with any solid-state speed control device to reduce the risk of fire or electric shock.
13. Avoid using in dusty environments.
14. Suitable for indoor use only.

ELECTRICAL CONNECTIONS



WARNING! READ THESE ELECTRICAL SAFETY INSTRUCTIONS THOROUGHLY BEFORE CONNECTING THE PRODUCT TO THE MAINS SUPPLY.

This product may be fitted with a non-rewireable plug. If it is necessary to change the fuse in the plug, the fuse cover must be refitted. If the fuse cover becomes lost or damaged, the plug must not be used until a suitable replacement is obtained.

If the plug has to be changed because it is not suitable for your socket, or due to damage, it should be cut off and a replacement fitted, following the wiring instructions shown below. The old plug must be disposed of safely, as insertion into a mains socket could cause an electrical hazard.



**WARNING! THE WIRES IN THE POWER CABLE OF THIS PRODUCT ARE COLOURED AS FOLLOWS:
Blue = Neutral Brown = Live Yellow and Green = Earth**

If the colours of the wires in the power cable of this product do not correspond with the markings on the terminals of your plug, proceed as follows.

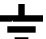
- Connect the **Blue** wire to the terminal marked **N**.
- Connect the **Brown** wire to the terminal marked **L**.
- Connect the **Yellow and Green** wire to the terminal marked **E** or 

Plug must be BS1363/A approved.

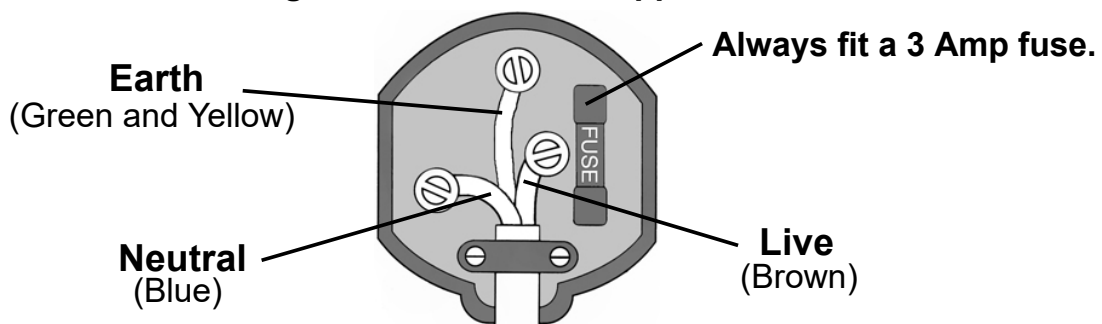

Ensure that the outer sheath of the cable is firmly held by the clamp

We strongly recommend that this machine is connected to the mains supply via a Residual Current Device (RCD)

If in any doubt, consult a qualified electrician. DO NOT attempt any repairs yourself.

COMPONENT PARTS

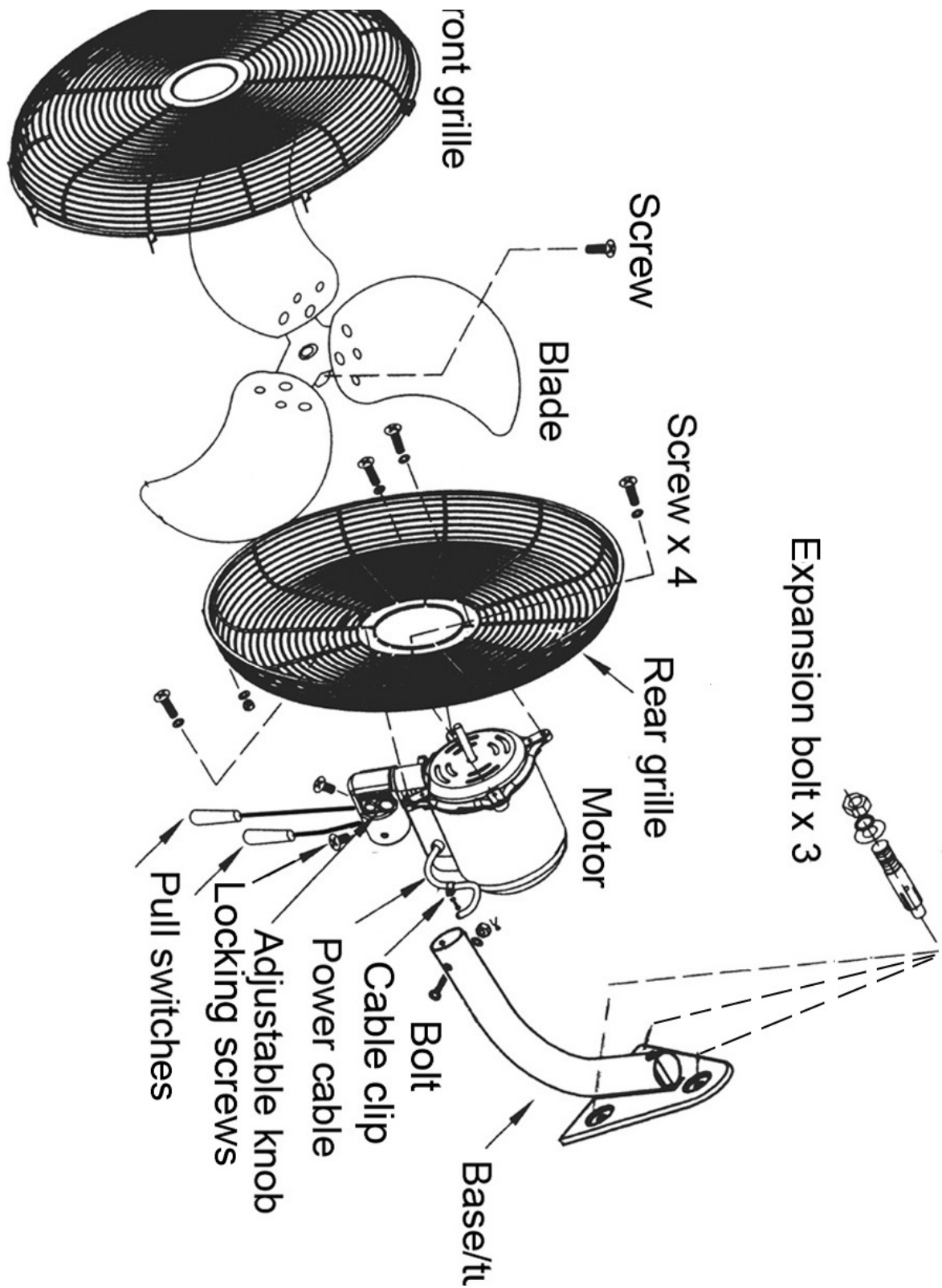

INSTALLATION

1. Attach the base/support tube to the wall at least 7 feet (2.5 metres) above the floor to provide adequate overhead clearance.
 - Expansion bolts are supplied for mounting to a masonry wall but if mounting to a timber structure, suitable woodscrews will be required.

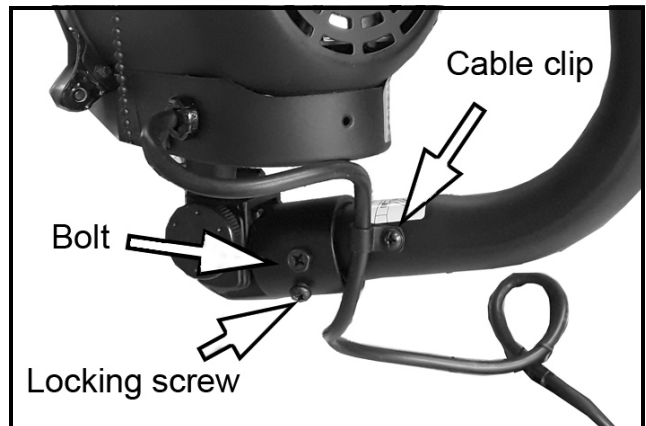

- The fan blade is attached to the rear grille with a plastic transit bracket that requires removal before assembly.

The fan blades are delivered, fixed to the rear grille as shown.



The two screws shown are also used to fix the grille to the fan motor assembly.

2. Retain these screws to fit the rear grille to the motor assembly.
3. Remove the blades from the shaft on the transit bracket by loosening the setscrew. The bracket then discarded.

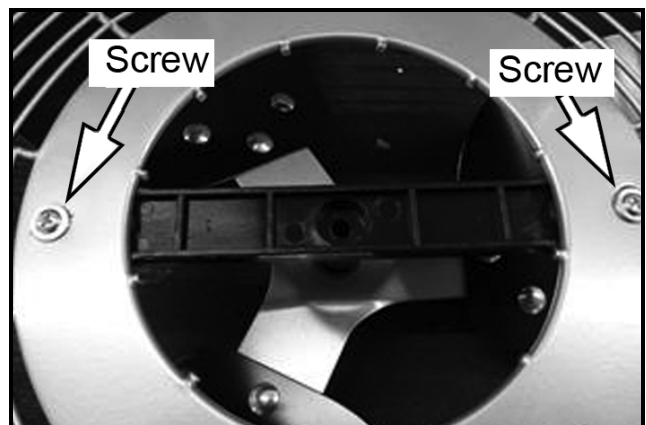

4. Retain the setscrew shown to secure the fan blades to the motor shaft.

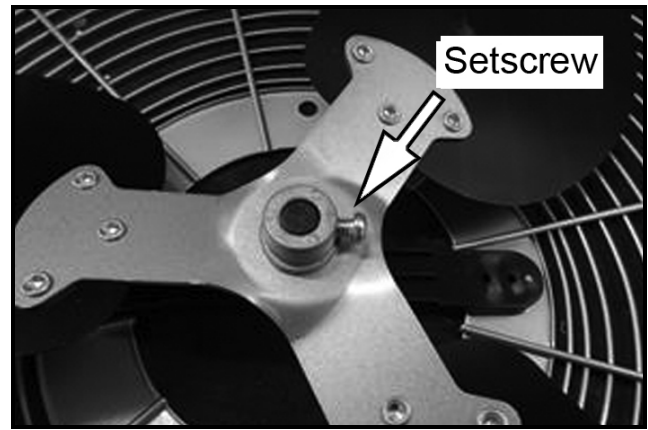

5. Attach the motor assembly to the base/tube with the bolt as indicated and tighten the 2 x locking screws.
6. Attach the power cable to the support tube with the cable clip.
7. Fit the rear grille over the motor shaft and secure with the 4 x screws.
8. Fit the fan blades to the motor shaft, ensuring the set screw is in line with the flat groove in the shaft. Tighten the setscrew securely.
9. Attach the front grille to the rear grille with the clips around the perimeter.

OPERATING

1. Adjust the angle of tilt by loosening the adjusting knob and positioning the fan as required. Re-tighten the knob to secure.

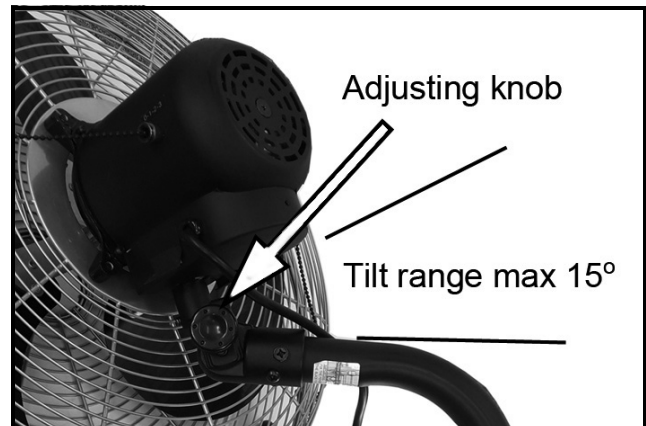

2. Pull the operating cord 1, 2 or 3 times, to select the fan speed required.
 - Position 0 - Off
 - Position 1 - 1200 rpm
 - Position 2 - 1280 rpm
 - Position 3 - 1360 rpm
3. Pull the other cord to set the fan oscillating if required.

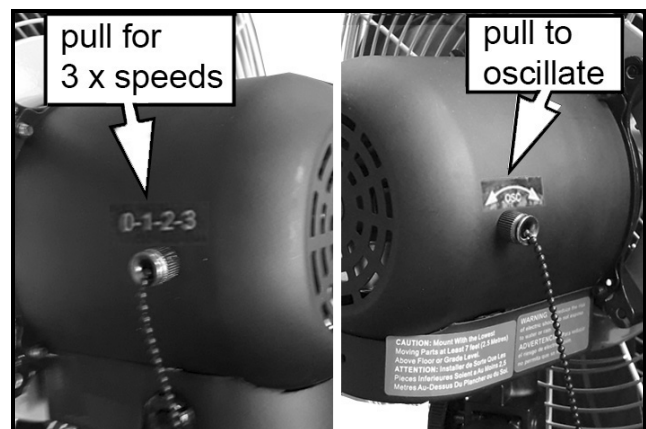

SPECIFICATIONS

MODEL	CHV18WF
Voltage	230 V AC (50Hz)
Wattage	120 W
Ingress protection rating	IPX0
Operating temperature range	10 to 25°C
Safety devices	Thermal link
Maximum air flow	70.3 m ³ /min
Fan Speeds	
Setting 1	1200 rpm
Setting 2	1280 rpm
Setting 3	1360 rpm
Max Fan Flow Rate	70 m ³ /min
Fan power input	92.8 W
Service value	0.8 m ³ /min/W
Fan sound power	63 dB
Maximum air velocity	4.0 m/s
Seasonal electricity consumption	29.7 kWh/a
Dimensions (W x H x D)	510 x 510 x 320 mm
Swivel range	15°
Weight	5.2 kg

MAINTENANCE



WARNING: NEVER OPERATE THE FAN WITH THE FRONT GRILL REMOVED. ALWAYS DISCONNECT THE POWER CABLE FROM THE POWER SUPPLY BEFORE PERFORMING MAINTENANCE WORK

Have any repairs carried out by a suitably qualified person.

- The motor bearings are permanently sealed for life and do not require any additional lubrication.

CLEANING

If the fan has been operating for long periods the blades and motor assembly may eventually require cleaning.

1. Release the clips retaining the front guard and lift it away carefully.
2. Wipe the fan blades with dry cloth and remove any dust from the motor assembly with a soft brush, vacuum cleaner or jet of compressed air.
 - Always wear a dust mask and glasses when using compressed air.
 - Never use any cleaning product or any corrosive liquid that will damage the surface finish.
3. Replace the guard securely before use.

DECLARATION OF CONFORMITY



Hemnal Street, Epping, Essex CM16 4LG

DECLARATION OF CONFORMITY

This is an important document and should be retained.

We hereby declare that this product(s) complies with the following statutory requirement(s):

Electromagnetic Compatibility Regulations 2016
Electrical Equipment (Safety) Regulations 2016
The Eco-Design for Energy Related Products and Energy Information (Amendment) (EU Exit) Regulations 2020
The Restriction of the Use of Certain Hazardous Substances in Electrical and Electronic Equipment Regulations 2012

The following standards have been applied to the product(s):

EN 55014-1:2006 + A1:2009 + A2:2011, EN 55014-1:2017, EN 55014-2:2015, EN 61000-3-2:2014, EN 61000-3-3:2013, EN 60335-1:2012 + A11:2014 + A13:2017 + A1:2019 + A14:2019 + A2:2019, EN 60335-2-80:2003 + A1:2004 + A2:2009, EN 62233:2008, EN 50565:2011, IEC 60879-1:1986/COR1:1992, EN 60704-1:2010 + A11:2012, EN 60704-2-7:1998, IEC 62321-7-1:2015, IEC 62321-3-1:2013, IEC 62321-5:2013, IEC 62321-4:2013, IEC 62321-7-2:2017, IEC 62321-6:2015, IEC 62321-8:2017

The technical documentation required to demonstrate that the product(s) meet(s) the requirement(s) of the aforementioned legislation has been compiled and is available for inspection by the relevant enforcement authorities.

The UKCA mark was first applied in: 2022

Product Description: 18" High Velocity Oscillating Wall Fan
Model number(s): CHV18WF
Serial / batch Number: N/A
Date of Issue: 05/10/2022

Signed:

J.A. Clarke
Director



Fitzwilliam Hall, Fitzwilliam Place, Dublin 2

DECLARATION OF CONFORMITY

This is an important document and should be retained.

We hereby declare that this product(s) complies with the following directive(s):

2014/30/EU Electromagnetic Compatibility Directive
2014/35 Low Voltage Directive
2009/125/EC Eco-Design, Energy Related Products Directive
2011/65/EU Restriction of the Use of Certain Hazardous Substances in Electrical & Electronic Equipment (RoHS) Directive

The following standards have been applied to the product(s):

EN 55014-1:2006 + A1:2009 + A2:2011, EN 55014-1:2017, EN 55014-2:2015, EN 61000-3-2:2014, EN 61000-3-3:2013, EN 60335-1:2012 + A11:2014 + A13:2017 + A1:2019 + A14:2019 + A2:2019, EN 60335-2-80:2003 + A1:2004 + A2:2009, EN 62233:2008, EN 50565:2011, IEC 60879-1:1986/COR1:1992, EN 60704-1:2010 + A11:2012, EN 60704-2-7:1998, IEC 62321-7-1:2015, IEC 62321-3-1:2013, IEC 62321-5:2013, IEC 62321-4:2013, IEC 62321-7-2:2017, IEC 62321-6:2015, IEC 62321-8:2017

The technical documentation required to demonstrate that the product(s) meet(s) the requirement(s) of the aforementioned directive(s) has been compiled and is available for inspection by the relevant enforcement authorities.

The CE mark was first applied in: 2020

Product Description: 18" High Velocity Oscillating Wall Fan
Model number(s): CHV18WF
Serial / batch Number: N/A
Date of Issue: 05/10/2022

Signed:

J.A. Clarke
Director

A SELECTION FROM THE VAST RANGE OF

Clarke®

QUALITY PRODUCTS



AIR COMPRESSORS

From DIY to industrial, Plus air tools, spray guns and accessories.

GENERATORS

Prime duty or emergency standby for business, home and leisure.

POWER WASHERS

Hot and cold, electric and engine driven - we have what you need

WELDERS

Mig, Arc, Tig and Spot. From DIY to auto/industrial.

METALWORKING

Drills, grinders and saws for DIY and professional use.

WOODWORKING

Saws, sanders, lathes, mortisers and dust extraction.

HYDRAULICS

Cranes, body repair kits, transmission jacks for all types of workshop use.

WATER PUMPS

Submersible, electric and engine driven for DIY, agriculture and industry.

POWERTOOLS

Angle grinders, cordless drill sets, saws and sanders.

STARTERS/CHARGERS

All sizes for car and commercial use.

PARTS & SERVICE: 0208 988 7400

Parts Enquiries
Parts@clarkeinternational.com

Servicing & Technical Enquiries
Service@clarkeinternational.com

SALES: UK 01992 565333 or Export 00 44 (0)1992 565335

Clarke INTERNATIONAL Hemnall Street, Epping, Essex CM16 4LG
www.clarkeinternational.com